

# Visit Pager Receiver

BE1470-868



## Features

**Discreet vibrations**  
Silent and non-intrusive

**Clear signal identification**  
Uses LEDs and vibration patterns

**Lightweight and portable**  
Wear it on the belt

**Replaceable front label**  
Easy to customize

**Optional charger accessory**  
With two bed shaker jacks

**MD**

CE-marked medical device  
under EU MDR 2017/745

## Fits your day, and your pocket.

The Pager Receiver from Bellman & Symfon is part of the Visit system that helps you to keep tabs on your home. It alerts you with gentle vibrations when the doorbell or telephone rings, when your baby needs you or if a fire should occur.

The Pager uses colored lights to differentiate the Visit signals and runs for up to three weeks on a single battery. It is robust and lightweight

and can be attached to your belt or tucked away in your pocket. Use it in and around the house to know whenever something happens that needs your attention.

The Pager Charger accessory features battery backup and outlets for two bed shakers. Just place it under your pillow or mattress to be alerted with vibrations if something happens during the night.



# Technical specifications



## Dimensions and weight

Height:	86 mm, 3.4"
Width:	57 mm, 2.2"
Depth:	29 mm, 1.1"
Weight:	70 g, 2.5 oz (incl. battery)



## Buttons and controls

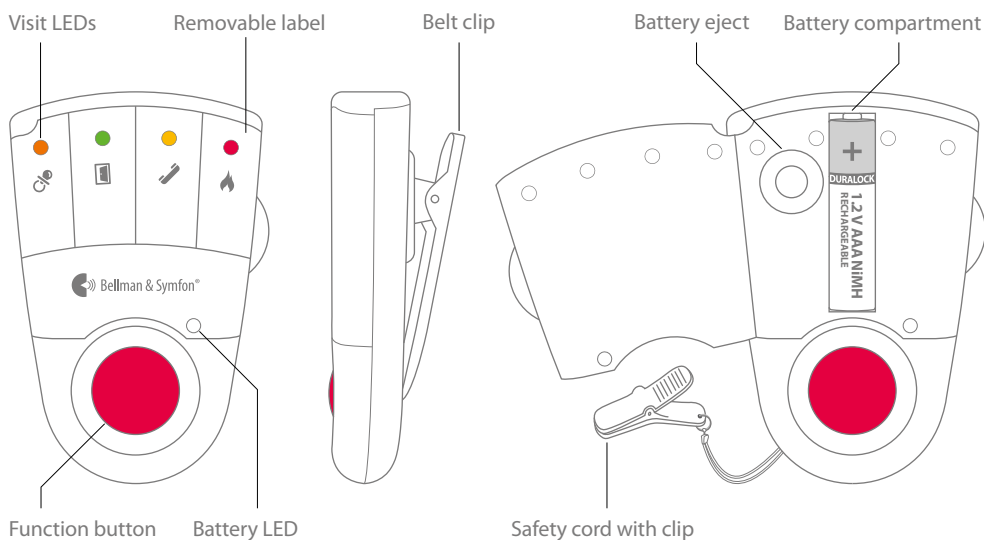

## Features

- Discreet alerts  
Produces silent and non-intrusive vibrations
- Clear signal identification  
Uses colored LEDs and vibration patterns
- Lightweight and portable  
Weights only 70 g
- Optional charger accessory  
Equipped with two bed shaker jacks

## Frequency and coverage

- Radio frequency: 868.3 MHz
- Coverage: 50 - 250 m (164 ft)

Coverage is depending on the radio frequency, building's characteristics and the combination of transmitters and receivers.

## Approvals



This product is a medical device in conformity with Regulation (EU) 2017/745 (Medical Device Regulation).

## Power and battery

- Mains power  
Powered via the BE1260 Pager Charger accessory
- Battery power  
1 x 1.5 V AAA Alkaline or  
1 x 1.2 V AAA NiMH rechargeable battery
- Power consumption  
Active: 220 mA, Idle position: 1 mA
- Operation time  
Alkaline batteries: 2 – 3 weeks  
NiMH batteries: ~1 week, fully charged

## In the box

- BE1470-868 Visit Pager Receiver
- Belt clip, safety cord, extra front label

## Environmental requirements

- Operating temperature: 0° to 35° C,  
32° to 95° F
- Relative humidity: 15% to 90%  
(non condensing)

## Visit indicators

The Visit LEDs normally indicates the following:

- Orange LED, pacifier symbol  
The baby monitor is activated
- Green LED, door symbol  
The door transmitter is activated
- Yellow LED, telephone symbol  
The telephone transmitter is activated
- Red LED, fire symbol  
The smoke alarm is activated
- Orange and Red LEDs blink alternately  
The CO alarm is activated

## Accessories

- BE1260-C Pager Charger
- BE1270-P02 Bed Shaker

© 2025 Bellman & Symfon AB. All rights reserved.

Bellman, Bellman & Symfon and the Bellman & Symfon logo are registered trademarks of Bellman & Symfon AB. This leaflet is subject to change without prior notice.

BE1470\_001DSH1.0\_EN

[bellman.com](https://bellman.com)