



VISIT: 001ART011-EN

# Pager charger

## Buttons and controls

Charger brackets

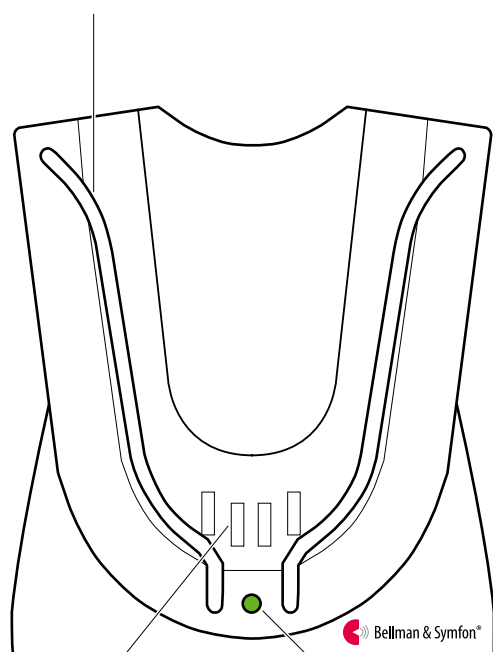

Charging pins

Charging LED

BE1270 bed shaker

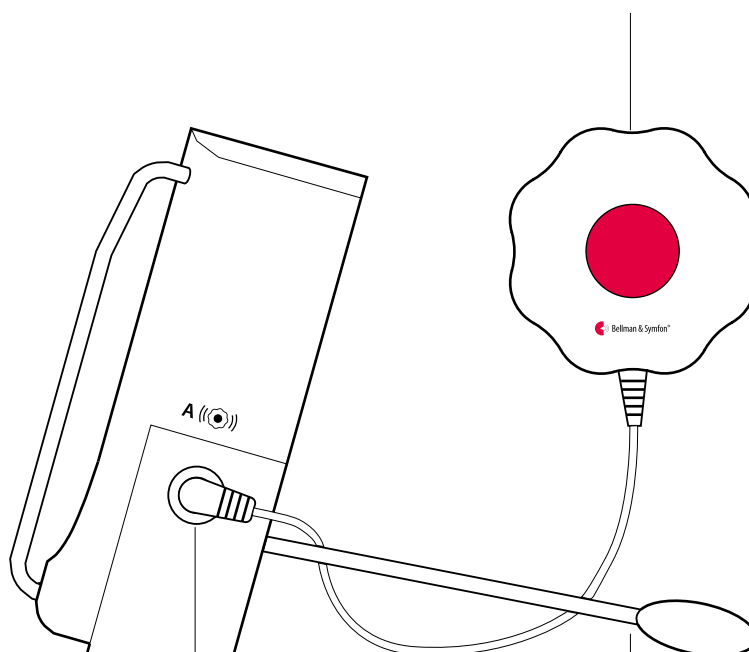

2 × bed shaker jacks

Supporting legs

## Technical specifications

### In the box

- BE1260 Pager charger with pre-mounted backup batteries
- External power supply
- 1 × 1.2 V NiMH rechargeable battery intended for the pager
- Supporting legs and screws + plugs

### Charging LED

- **Green light:** The pager is charging
- **No light:** The pager is fully charged or the power supply is not connected to mains power.

### Power and battery

- Mains power: 8 VDC / 800 mA
- Battery power  
4 × 1.2 V NiMH rechargeable batteries

**Note:** The backup batteries must be changed at a service centre.

- Pager charging time  
Normal charging time:  
~ 6 h  
With depleted backup batteries:  
~ 24 h
- Vibrator power: 2.0 – 4.0 VDC

### Dimensions and weight

- Height: 78 mm, 3.1"
- Width: 88 mm, 3.5"
- Depth: 43 mm, 1.7"
- Weight: 200 g, 7 oz. incl. batteries and power adapter

### Environment

- For indoor use only

### Accessories

- BE1270 Bed shaker  
Connects up to two bed shakers



**Warning!** When using the pager charger **ONLY USE RECHARGEABLE NiMH BATTERIES** in the pager. Non-rechargeable batteries will start to leak if the pager is placed in the charger and the battery acid will damage the electronics. The resulting damage is not covered by warranty.

# Pager charger

## Getting started

- 1 Important!** Replace the old alkaline battery with the supplied 1.2 V NiMH rechargeable battery.
- Fit the supporting legs to the back of the charger and place it on a level surface. You can also mount it on the wall using the supplied screws and plugs.
- Connect the power supply to the mains outlet and place the pager in the charger. The charging LED is green during charging and goes out when the pager is fully charged. Connect the bed shaker and tuck it under the pillow or mattress.

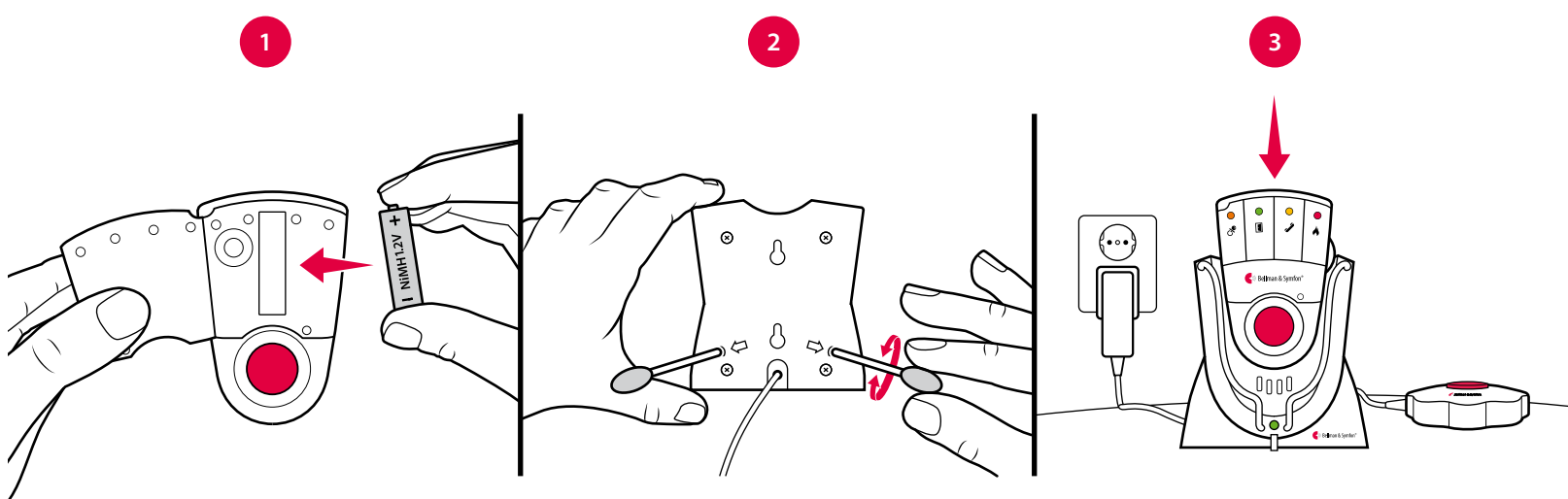

## Testing the connection

**Note:** Charge the backup batteries for 24 hours before using it with a bed shaker.

- To test the radio link you need the pager and a Visit transmitter. Press the test button/s on the transmitter (see **Testing the connection** for the relevant transmitter).
- If the pager is placed in the charger, it lights up a Visit LED and the bed shaker starts to vibrate. If nothing happens, see **Troubleshooting**.

## Troubleshooting

Most problems with the charger can be solved quickly by following the advice below.

If	Try this
The pager doesn't charge when it's placed in the charger	<ul style="list-style-type: none"> <li>Check that the pager is positioned correctly in the charger. The charging LED will light up in green to show that the pager is being charged.</li> <li>If the charging LED doesn't light up, the backup batteries may be depleted. Connect the power supply to mains power and charge the backup batteries.</li> </ul>
The bed shaker doesn't vibrate when the pager is activated	<ul style="list-style-type: none"> <li>Check that the bed shaker is connected correctly to the charger.</li> <li>Check that the pager is positioned correctly in the charger. The charging LED will light up in green to show that the pager is being charged.</li> <li>If the charging LED doesn't light up, the backup batteries may be depleted. Connect the power supply to mains power and charge the backup batteries.</li> </ul>