

# Amicus repeater

Model: BE2371



## Features

The Amicus repeater extends the range of the system by up to 600 meters (line of sight). It is easy to install and is equipped with battery backup that steps in when the power goes out.



### Superior range

Extends the range by up to 600 m so the caregiver can move around freely in and around the premises.



### Battery backup

Equipped with backup batteries that step in when the power goes off, offering increased safety for the caretaker.



### Easy setup

Works out of the box and takes only minutes to install. Just pair it with the transceiver and you are up and running.



### Reliable and secure

Automatic supervision of sensor, battery and network status, providing high system reliability and resident security.

# Technical specifications



## Dimensions and weight

Height: **140 mm**  
 Width: **105 mm**  
 Depth: **30 mm**  
 Weight: **210 g incl. batteries**



## Connections

- 1 x 7.5V power cord

## Frequency and coverage

- Radio frequency: 869.2375 MHz
- Coverage: Up to 600 meters (line of sight). The range is reduced by walls and large objects that obstruct radio signals. The range can also be affected by other radio transmitters such as TVs, PCs, and mobile phones. Thick walls of reinforced concrete will reduce the range significantly.

## Maintenance and cleaning

- To clean the product, unplug the power cord and use a soft, lint-free cloth. Avoid getting moisture in openings.
- Don't use window- or household cleaners, aerosol sprays, solvents, alcohol, ammonia, or abrasives.

## Power and battery

- Mains power**  
 Input: 100 – 240 V ~ 50/60 Hz 0.3 A  
 Output: 7.5 V  $\Rightarrow$  1000 mA  
 Only use the supplied power supply SSA-10W-12 EU 075100 by SIL
- Batteries**  
 With mains electricity  
 4 x 1.2 V AAA rechargeable NiMH batteries. Only use the supplied rechargeable batteries model HFR AAA900 900 mAh by Shenzhen Highpower Technology Co. Ltd., or model 5703 1000 mAh by Varta.  
 Without mains electricity  
 4 x 1.5V AAA alkaline batteries.
- Battery operating time**  
 1 year with alkaline batteries
- Power consumption**  
 0.3 mA

## In the box

- BE2371 Amicus repeater with pre-installed batteries
- Power supply
- Screws and plugs
- User manual



## Environment

- For indoor use only
- Temperature: 15° - 35° C
- Relative humidity: 5% - 95%, non-condensing

## Regulatory requirements

- Complies with the following requirements: CE, WEEE, R&TTE and RoHS



## Buttons and indicators

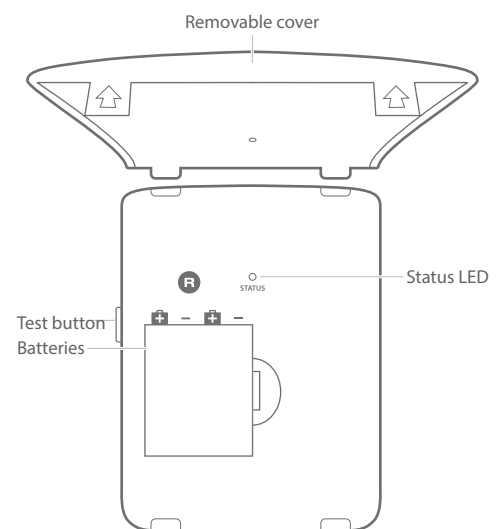

## Repeater inputs

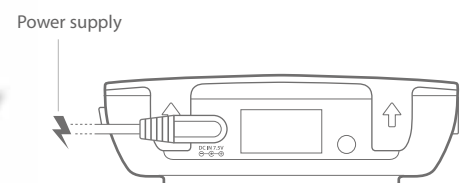

© and TM 2017, Bellman & Symfon AB

Amicus, Bellman and Bellman & Symfon are registered trademarks owned by Bellman & Symfon AB, all rights reserved. All product designs are patented. This leaflet is subject to change without prior notice.

BE2371\_001DSH001

[bellman.com](http://bellman.com)