

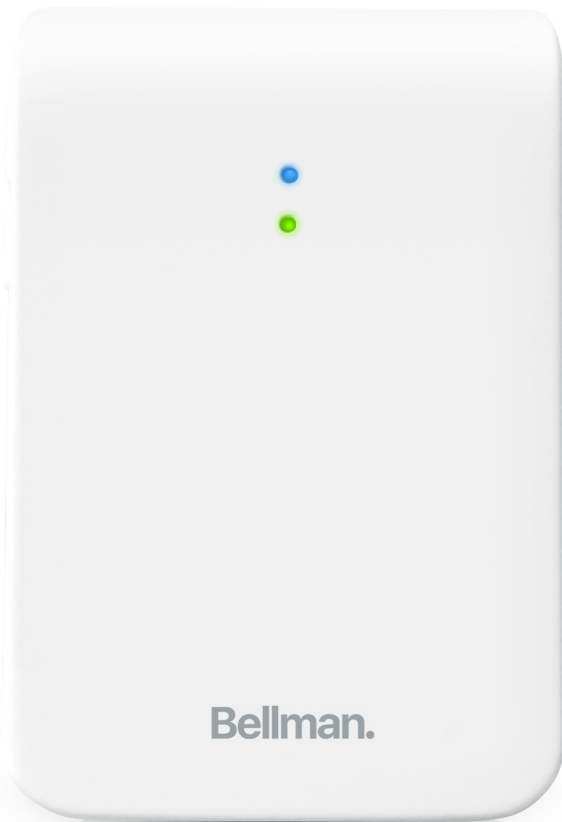

# Bridge Transceiver

BE1521-868



**Bellman.**



**Features**

- Bluetooth technology**  
Up to 250 m range, line-of-sight
- App compatible**  
Available for iOS & Android
- Two-way communication**  
Connects Visit to smart devices and Bellman Bluetooth alerting products

**MD** CE-marked medical device under EU MDR 2017/745

## Connects Visit to your Bluetooth receivers and smart devices.

The Bridge Transceiver connects your Visit system to your Bellman Bluetooth receivers, mobile phones and tablets using Bluetooth technology. It works in two directions, enabling you to receive Visit alerts on your Bluetooth products and smart devices, while also forwarding alerts from your mobile phone to your receivers.

The Assistant app offers easy access to and control of your notifications.

The Bridge Transceiver features an external trigger input, as well as RJ12 telephone and relay outputs.

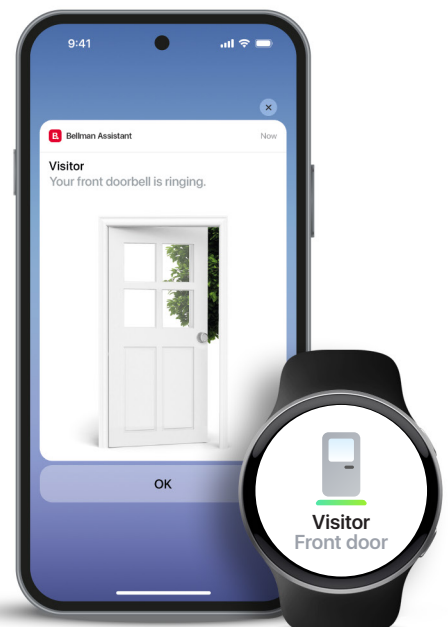

# Technical specifications



## Dimensions and weight

Measures: 100 × 65 × 27 mm, 4.0 × 2.6 × 1.1"

Weight: 198 g, 6.98 oz. including batteries, telephone cable and power cable



## Buttons and connectors

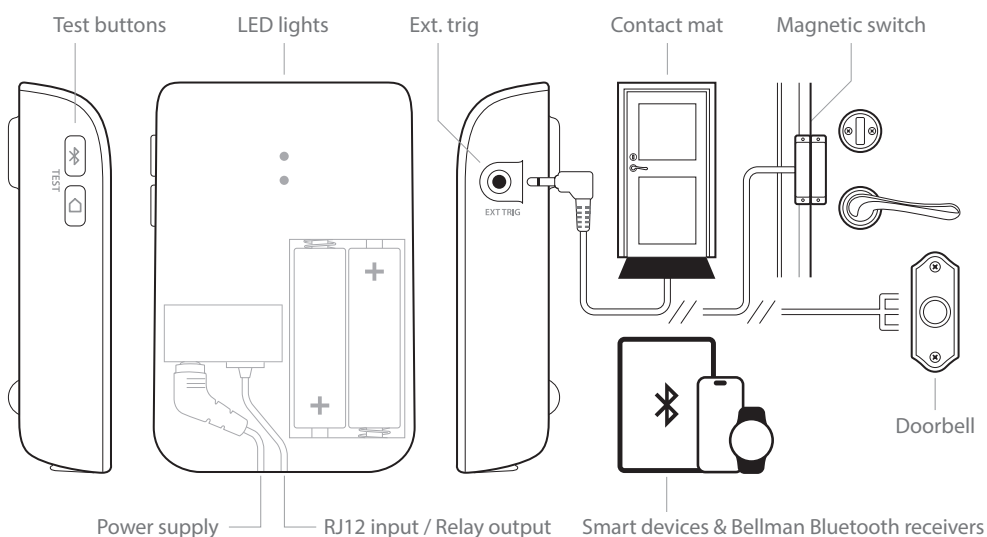

## Connections

- Bellman Bluetooth alerting products, smartphones and tablets via Bluetooth
- Visit transmitters and receivers via 868 MHz
- Landline telephone trig input via RJ12
- Relay output via RJ12
- Original accessories via ext trig input

## Environmental requirements

- For indoor use only
- Operating temperature: 0 to 35 °C, 32 to 95 °F
- Relative humidity: 15% to 90%, non condensing

## Number of ISM radio keys

- 64 as standard

## Power and battery

- Mains power: 5 V DC / 1000 mA
- Backup batteries: 2 × 1.5 V AA Alkaline (included)

## Maintenance and cleaning

- Use a soft, lint-free cloth. Avoid getting moisture in openings. Don't use household cleaners.

## Frequency and coverage

- ISM frequency: 868,30 MHz
- ISM transmission power: 3 mW (max.)
- ISM range: Up to 200 m, 220 yd line-of-sight
- Bluetooth frequency: 2400 – 2483.5 MHz
- Bluetooth transmission power: 3 mW (max.)
- Bluetooth alerting system:  
Up to 250 m, 270 yd, line-of-sight
- Bluetooth smartphone:  
Up to 40 m, 44 yd, line-of-sight

## Compatibility

- iOS15 | Android 8.0 and later

## Accessories

- BE9023-P02 Magnetic Switch
- BE9026-P02 Contact Mat
- BE9253 3.5 mm External Trigger Cable

## Approvals



This product is a medical device in conformity with Regulation (EU) 2017/745 (Medical Device Regulation).

## In the box

- BE1521-868 Bridge Transceiver
- Power supply
- Screw and plug



© and TM 2026 Bellman & Symfon AB

Bellman and Bellman & Symfon are registered trademarks owned by Bellman & Symfon AB, all rights reserved. This leaflet is subject to change without prior notice.

BE1521-868\_113DSH3.0\_EN

[bellman.com](http://bellman.com)