

Visit Pager Receiver

BE1470



Features

Discreet vibrations
Silent and non-intrusive

Clear signal identification
Uses LEDs and vibration patterns

Lightweight and portable
Wear it on the belt

Replaceable front label
Easy to customize

Optional charger accessory
With two bed shaker jacks

Fits your day, and your pocket.

The Pager Receiver from Bellman & Symfon is part of the Visit system that helps you to keep tabs on your home. It alerts you with gentle vibrations when the doorbell or telephone rings, when your baby needs you or if a fire should occur.

The Pager uses colored lights to differentiate the Visit signals and runs for up to three weeks on a single battery. It is robust and lightweight

and can be attached to your belt or tucked away in your pocket. Use it in and around the house to know whenever something happens that needs your attention.

The Pager Charger accessory features battery backup and outlets for two bed shakers. Just place it under your pillow or mattress to be alerted with vibrations if something happens during the night.



Technical specifications



Dimensions and weight

Height: **86 mm, 3.4"**
Width: **57 mm, 2.2"**
Depth: **29 mm, 1.1"**
Weight: **70 g, 2.5 oz (incl. battery)**



Buttons and controls

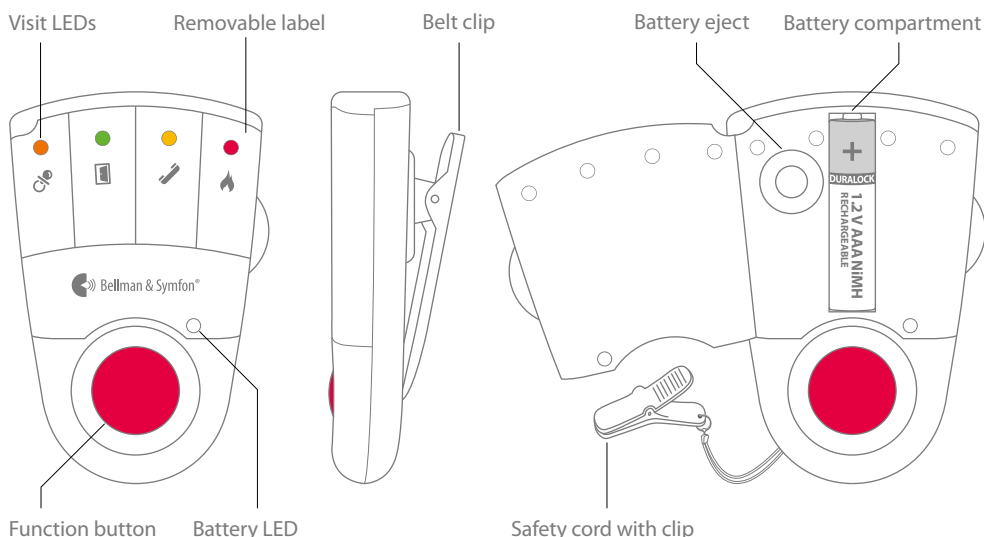

Features

- Discreet alerts
Produces silent and non-intrusive vibrations
- Clear signal identification
Uses colored LEDs and vibration patterns
- Lightweight and portable
Weights only 70 g
- Optional charger accessory
Equipped with two bed shaker jacks

Frequency and coverage

- Radio frequency: 315 MHz
- Coverage: 30 - 80 m (164 ft)
Coverage is depending on the radio frequency, building's characteristics and the combination of transmitters and receivers.

Compliance

This product complies with applicable FCC and ISED Canada regulations.
本機器は日本の電波法に適合しています。

Power and battery

- Mains power
Powered via the BE1260 Pager Charger accessory
- Battery power
1 x 1.5 V AAA Alkaline or
1 x 1.2 V AAA NiMH rechargeable battery
- Power consumption
Active: 220 mA, Idle position: 1 mA
- Operation time
Alkaline batteries: 2 – 3 weeks
NiMH batteries: ~1 week, fully charged

In the box

- BE1470 Visit Pager Receiver
- Belt clip, safety cord, extra front label

Environmental requirements

- Operating temperature: 0° to 35° C,
32° to 95° F
- Relative humidity: 15% to 90%
(non condensing)

Visit indicators

The Visit LEDs normally indicates the following:

- Orange LED, pacifier symbol
The baby monitor is activated
- Green LED, door symbol
The door transmitter is activated
- Yellow LED, telephone symbol
The telephone transmitter is activated
- Red LED, fire symbol
The smoke alarm is activated
- Orange and Red LEDs blink alternately
The CO alarm is activated

Accessories

- BE1260 Pager Charger
- BE1270 Bed Shaker (connected to the charger)

© 2025 Bellman & Symfon AB. All rights reserved.

Bellman, Bellman & Symfon and the Bellman & Symfon logo are registered trademarks of Bellman & Symfon AB.
This leaflet is subject to change without prior notice.

BE1470-315_001DSH1.0_EN

bellman.com